

Optica student chapters are encouraged to apply for a [Special Program Grant](#)* for up to \$300! This grant is directly managed by Optica.

*Note that receiving a Special Program Grant **will not** affect a chapter's ability to tap into the full \$1,500 of Optica Student Chapter Funding. For any problem, please contact studentchapters@optica.org. Follow the instructions on how to apply for funding.

Only the officer or the member of the chapter who holds the right to apply for grants can do so!



Log In with your Optica account.

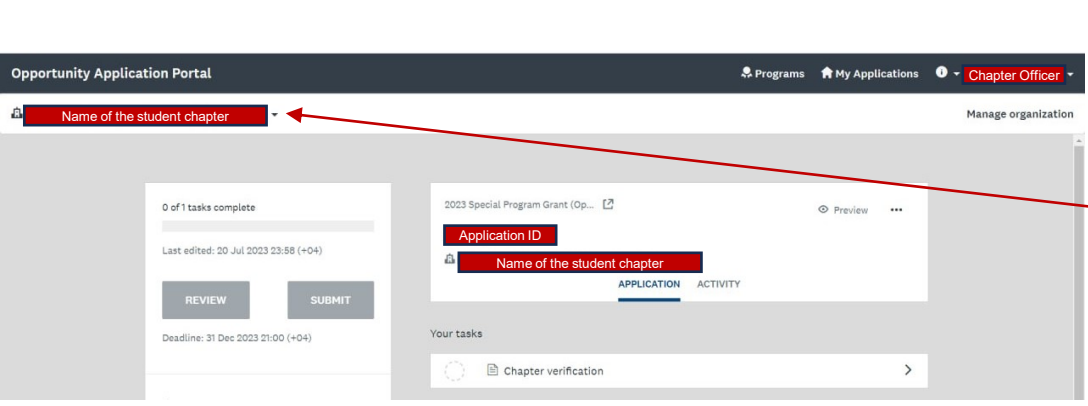

Choose the chapter. If you do not see this option, it means you do not have permission to ask for a grant for the student chapter. Please, check with the other members/officers of the chapter or contact studentchapters@optica.org

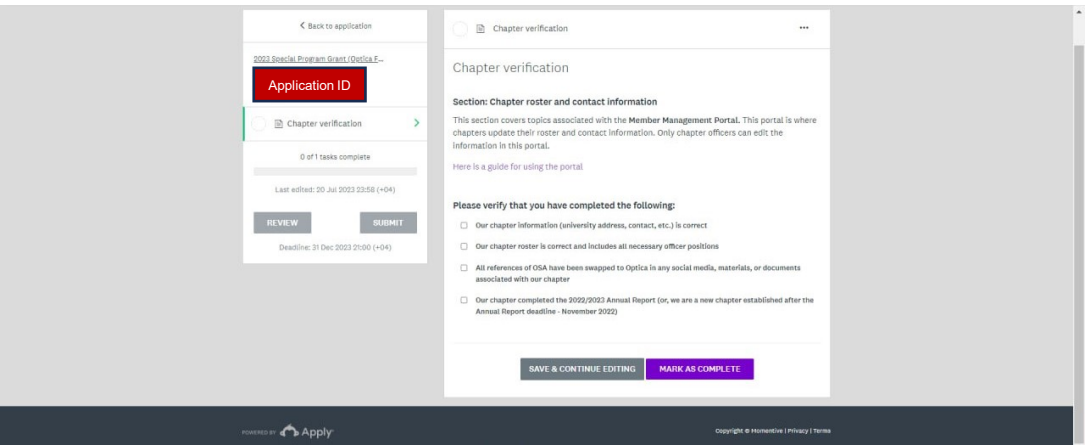

Follow the guide to using the portal or continue reading this document! Verify the information about your chapter and press **MARK AS COMPLETE.**

Application ID



Chapter Information



Special Program Grant: Tell us about your event



Finance Forms

1 of 3 tasks complete



Last edited: 27 Jul 2023 18:06 (+0+)

REVIEW

SUBMIT

Deadline: 31 Dec 2023 21:00 (+0+)

Special Program Grant: Tell us about your event

Name of event

POM23 CHAPTER NAME-HUB

Start date of event

13/11/2023

End date of event

14/11/2023

What is the focus area for this event?

Select all that apply

- Diversity and inclusion
- Professional development
- Education outreach
- Stress/mental health awareness
- Other, please specify...

Estimated number of people to be impacted

Number of attendees

Please list any partnering and/or sponsoring organizations and any financial benefit they are providing

Fill in according to your chapter

Please list any partnering universities/student chapters working with yours on this event

Fill in according to your chapter

Brief summary of event

Max: 500 words

Describe how you will hold a local POM-HUB

How does this event support your community?

Max: 500 words

Describe the benefits of your HUB

Total funding required for a successful event

This amount should include all sponsors you anticipate soliciting

\$ Budget in total for your event

Funding required from Optica

Max: \$1,500 USD. Events including diversity, equity, and inclusion programming: \$3,000 USD

*If you are applying for funding to host a group event for the Photonics Online Meetup (POM), please note the grant amount will be \$300.

\$ Max 300\$

In detail, please provide how the money received from Optica will be used

(itemizing by cost is most effective (ex: \$500 for food, \$200 for marketing materials, etc.)

Details how a maximum of 300\$ will be used for your event

Are you hosting an event of significant magnitude that would require funding beyond \$1,500? If your event meets certain criteria, you could qualify for additional support:

An extra \$1.5K USD for chapters in emerging economies

An extra \$3.5K USD for chapters in established economies

To qualify, your event must:

- Recognize Optica as a main sponsor
- Be at least three days in length
- Include:
 - Technical presentations from professionals and students
- Recognize Optica as a main sponsor
- Be at least three days in length
- Include:
 - Technical presentations from professionals and students
 - Professional development sessions
 - Industry-focused opportunities
 - Diversity and inclusion programming
 - Cultural exchange opportunities
 - Lab tours
 - Social events that highlight the city/culture

Would you like your application to be considered for this extra funding?

- Yes
- No - our event does not qualify
- No - our event qualifies but we do not need extra funding

Please complete the correct packet for your chapter.

US chapters

- **Complete this form**
- Further information on the W9 tax form

International chapters where the account holder is an organization (university).

- **Complete this form**
- Wire form instructions

International chapters where the account holder is a person

- **Complete this form**
- Wire form instructions

International chapters where the account holder is an entity (association, group, etc.)

- **Complete this form**
- Further information on the W8 BEN-E tax form
- Wire form instructions

 Upload a file

Application ID

Chapter Information

Special Program Grant: Tell us about your event

Finance Forms 

2 of 3 tasks complete

Last edited: 27 Jul 2023 19:00 (+04)

REVIEW **SUBMIT**

Deadline: 31 Dec 2023 21:00 (+04)

Complete the financial form. For help check the instructions from the [Optica page](#).